



# BILLET ALUMINUM DOOR HANDLE INSERTS

(2007-2018 WRANGLER JK 4-DOOR)

---

## INSTALLATION INSTRUCTIONS

### CONTENTS

---

(5) Door Handle Inserts  
(5) Push Button Covers  
(10) Screws

### TOOLS REQUIRED

---

Isopropyl Alcohol  
Towel  
Phillips Screw Driver  
Drill  
Drill Bit

SKU # J142001-J142005

**STEP 1**



Begin by cleaning the door handles. \*\*Recommended: Wipe the door handles down with isopropyl alcohol to ensure the door handles are free of clean of wax/ grease.

**STEP 2**

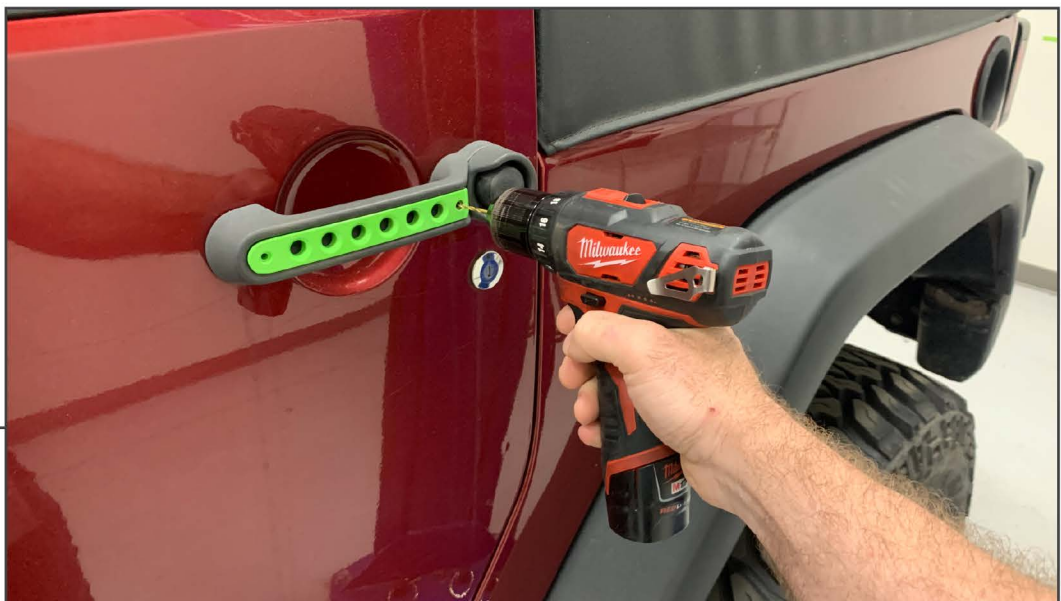

Position the door handle inserts on the door handle. Mark and pre-drill the screw locations to 3/32".



**STEP 3**

Install the door handle insert using the provided Phillips head screws.



**STEP 4**

Peel back the tape backing from the push button covers. Press the covers onto the vehicle. Apply firm even pressure to ensure the proper adhesion. Repeat the process on the remaining door handles. Installation is now complete.