

LED PROJECTOR HEADLIGHTS W/ DRL & SEQUENTIAL TURN SIGNALS

(2010-2014 MUSTANG)

INSTALLATION INSTRUCTIONS

CONTENTS

- (1) LH Headlight
- (1) RH Headlight
- (1) DRL Harness
- (2) Halogen Wiring Harnesses (Pre-Installed)
- (2) HID Wiring Harnesses
- (8) Cable Ties

TOOLS REQUIRED

- 7mm, 8mm, 10mm, 19mm Sockets
- Ratchet
- Panel Removal Tool
- Jack and Jack Stands

STEP 1

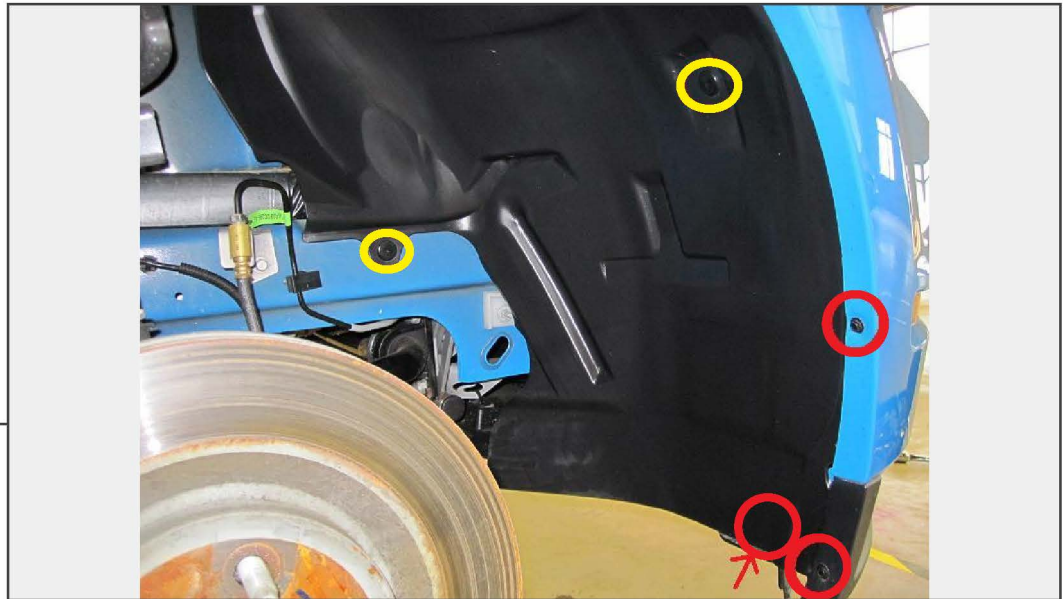

Lift and support the vehicle using a jack and jack stands. Remove the wheel from the vehicle. Remove (3) 7mm screws and (2) plastic push clips from the inner fender liner.

Repeat this procedure for the opposite side of the vehicle.

STEP 2

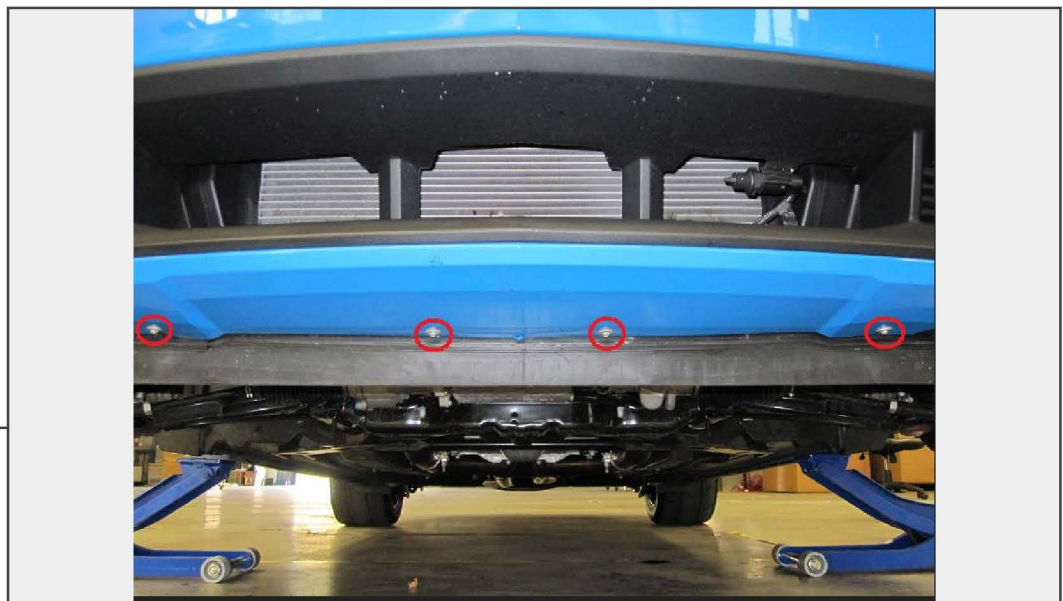

Remove (4) 7mm screws from the lower portion of the bumper.



STEP 3

Remove (8) plastic push clips using a panel removal tool. Lift the radiator support cover from the vehicle and set aside.

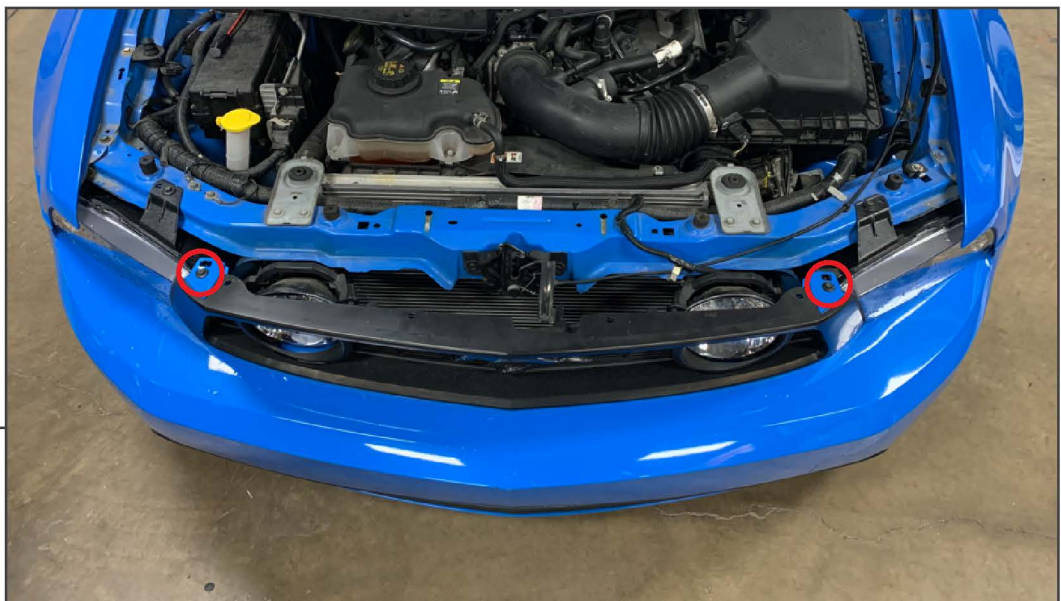

STEP 4

Remove (2) 8mm bolts from the bumper assembly. Lift the bumper over the (2) plastic tabs to allow the front of the bumper to move forward on the vehicle.

STEP 5



Grab the corner of the bumper where it meets the fender, and firmly pull forward to allow the bumper to separate from the fender on both sides of the vehicle. Disconnect the side marker light connectors and fog light connectors. Lift and set bumper aside carefully to prevent damage.

STEP 6

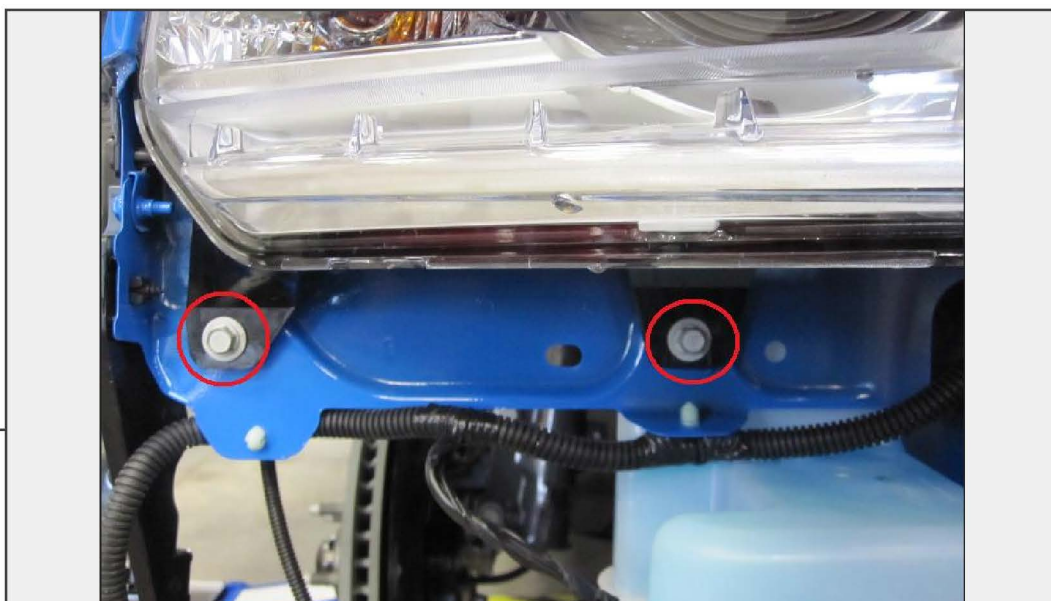

Remove (2) 10mm bolts from underneath the headlight assembly.

Repeat this procedure for the opposite side of the vehicle.



STEP 7

Remove (1) 10mm bolt from the top of the headlight in the radiator support. Pull the headlight from the vehicle and unplug the (2) electrical harnesses.

Repeat this procedure for the opposite side of the vehicle.

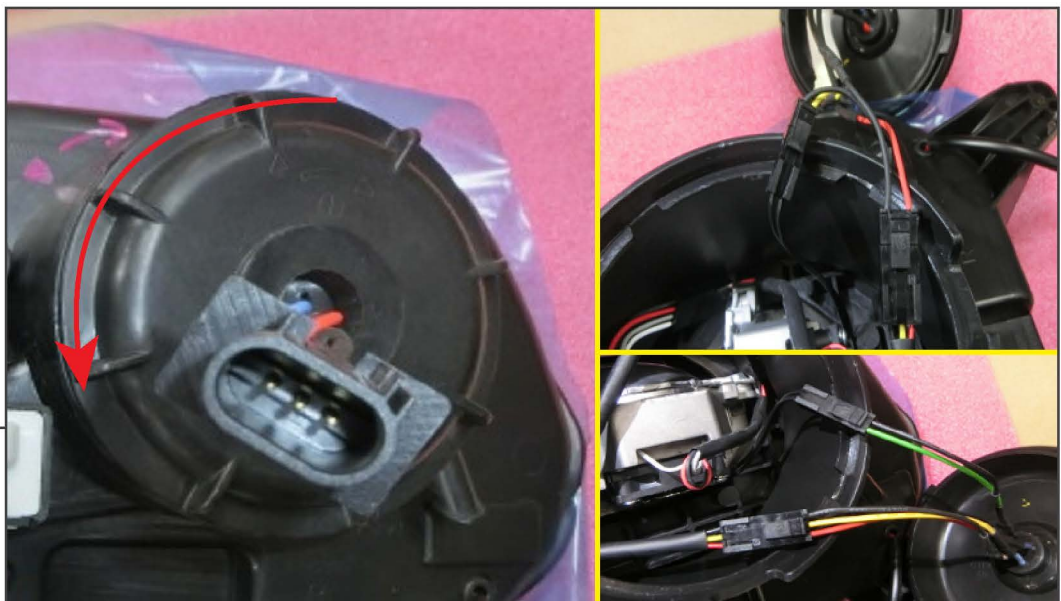

STEP 8

With the headlight assembly unplugged, determine if the vehicle has OEM halogen OR OEM HID headlights by inspecting the electrical connector (3 Wires = OEM Halogen / 4 Wires = OEM HID).

If vehicle has OEM halogen headlights: Do not remove the pre-installed connector.

If vehicle has OEM HID headlights: Remove the pre-installed headlight connector by twisting the seal counter clockwise, and unplug the (2) electrical connectors. Install the provided HID compatible headlight connector by plugging in the connectors, and twisting the seal clockwise to lock into place.

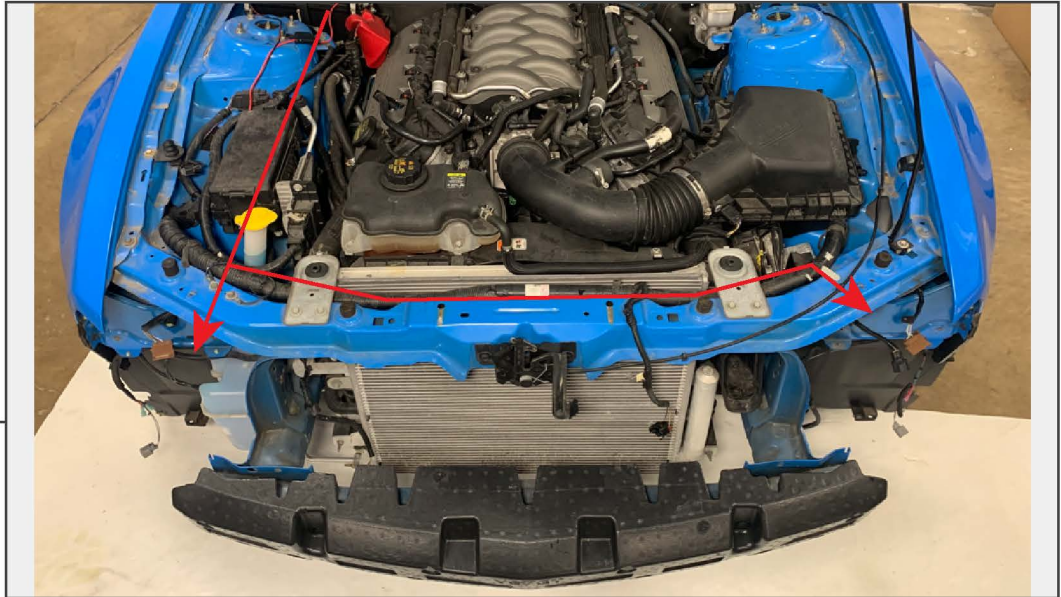

STEP 9

Route the provided (1) DRL harness neatly across the engine bay. Ensure the power/ground leads are routed towards the RH side of the vehicle. Connect the wire leads to the vehicle battery terminals.

<u>Vehicle Battery</u>	-	<u>DRL Harness</u>
Positive Terminal (+)	-	Red Wire (+)
Negative Terminal (-)	-	Black Wire (-)

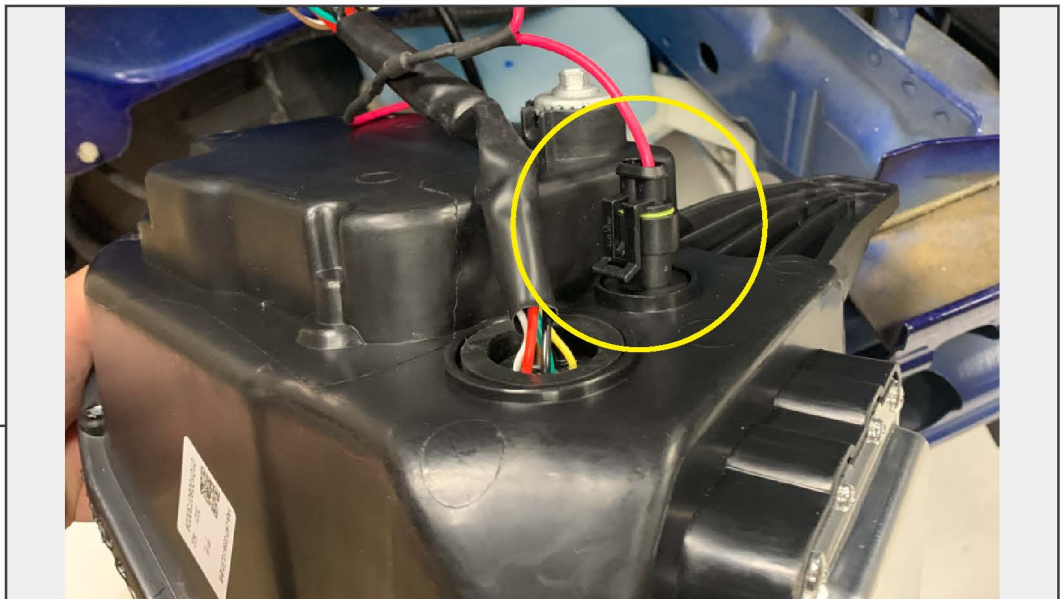

STEP 10

Plug the DRL harness into the backside of the headlight assembly. Plug in the (2) headlight wiring harnesses into the corresponding vehicle harness. Ensure the connectors click into place secure the connection.

Repeat this procedure for the opposite side of the vehicle.

STEP 11



Secure the new headlight into the vehicle reusing the (3) original 10mm bolts. Tighten until secure.

Repeat this procedure for the opposite side of the vehicle.

STEP 12



Re-assemble the vehicle following steps 1-5 in reverse order.

**There is a slight delay of the DRL when initially turning the lights on. Once the system is charged there will not be a delay.

Installation is now complete.